

**ADDENDUM NO. 1**  
**FOR**  
**MONTE SANO TRAILHEAD FACILITIES PAVILION WITH**  
**RESTROOMS INCLUDING ACCESSIBLE PARKING**  
**RTP PROJECT NO. 15-RT-54-02**  
**DCNR PROJECT NO. 47-P-55**  
**BC PROJECT NO. 2018397**

**NOVEMBER 16, 2018**

TO: ALL PLAN HOLDERS AND INTERESTED PARTIES

SUBJECT: Plans, Specifications, and Contract Documents are hereby amended, modified, and changed as follows:

I. Reference Par V – Special Conditions, Table of Contents

A. Add Part No. 14 to read Purchases of American-Made Equipment and Products.

II. Reference Part V – Special Conditions, Page V-5

A. Add the following paragraph.

14. Purchases of American-Made Equipment and Products

A. The Contractor agrees to abide by the Buy America law as identified in 23 USC 313 and comply with the Federal Highway Administration's (FHWA) regulatory policy regarding Buy America identified in 23 CFR 635.410.

B. Included in this requirement is that for all steel or iron materials used in the project, all manufacturing processes, including application of a coating, must be performed in the United States.

C. Contractor shall be required to submit a certification on company letterhead with each pay request that indicates compliance with Buy America requirements and that all materials provided on the project comply with Buy America.

B. Attached is a Sample Certification Letter included on Page ADM1-3

III. Reference Part VI, Divison 3, Concrete

A. All concrete shall include poly fibers at the rate of 1 pound per cubic yard of concrete, in addition to reinforcement or WWF as shown on plans.

B. Parking area and floor slab shall receive broom finish.

IV. Reference Plans

- A. Add the enclosed plate details on page ADM1-3 to Sheet A3.
- B. On Sheet A3, enlarged detail 3/A3, it is the contractor's option for an end wall truss in lieu of building the end wall as shown on detail. The end wall truss will be a standard gable end wall truss that accommodates a louver as shown on detail.
- C. The term "timber" on the drawings does not indicate a specific wood species. Refer to the specifications.
- D. All exposed lumber is to be painted or stained. Color as selected by Architect and Owner.

V. The following Pre-Bid Minutes are Included by Addendum and made part of the Contract Documents.

- A. A Pre-Bid Conference was held on Tuesday November 9, 2018 at Monte Sano State Park Lodge at 11:30 a.m. James Payton with Ladd Environmental Consultants, Inc. moderated the conference. An attendance list is attached on page ADM1-4.
- B. Ken Thomas of State Parks discussed Buy America requirements. Refer to paragraph II above.
- C. A question was asked about timbers and beams on the pavilion. Dimensional lumber is specified with the goal of an appearance of beams. Refer to paragraph IV above.
- D. A question was asked about the plates on the trusses. Refer to paragraph IV above.
- E. A question was asked about payment for rock. There is no additional payment for rock encountered during construction.
- F. A discussion was conducted about fiber reinforcement and welded wire fabric in concrete and finishes on concrete. Refer to paragraph III for additional concrete requirements.
- G. A question was asked about connecting the wood tables to the split face block. Detail A on sheet A3 shows the table connection. It is acknowledged by the Owner that the connection will not be flush to the split face block, and no caulking or grouting will be required to fill voids.

THIS ADDENDUM ISSUED THIS 16<sup>th</sup> DAY OF NOVEMBER 2018.

LADD ENVIRONMENTAL CONSULTANTS, INC.

*James Payton*

James Payton, P.E.

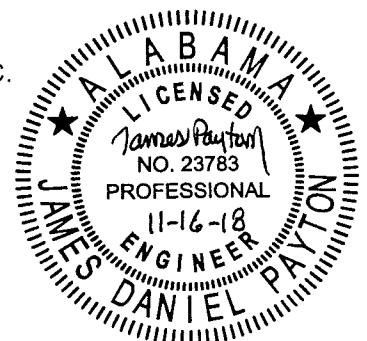



**PATRICIA E. SHERMAN**  
**ARCHITECT**  
 MEMBER AMERICAN INSTITUTE OF ARCHITECTS  
 307 WALL STREET  
 GADSDEN, AL 35904  
 256/546-6112 FAX: 256/546-6115

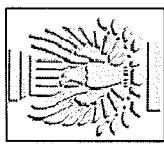

**MONTESAND TRAILHEAD FACILITIES**  
**PAVILION**  
 DCNR# 47-P-55 D/A # 2017346  
 FOR THE ALABAMA DEPT. OF CONSERVATION  
 AND NATURAL RESOURCES

DRAWN	NS
CHECKED	PES
SCALE	3/4" = 1'-0"
DATE	11/14/23
FILE	
JOB NO.	18-16
REVISIONS	

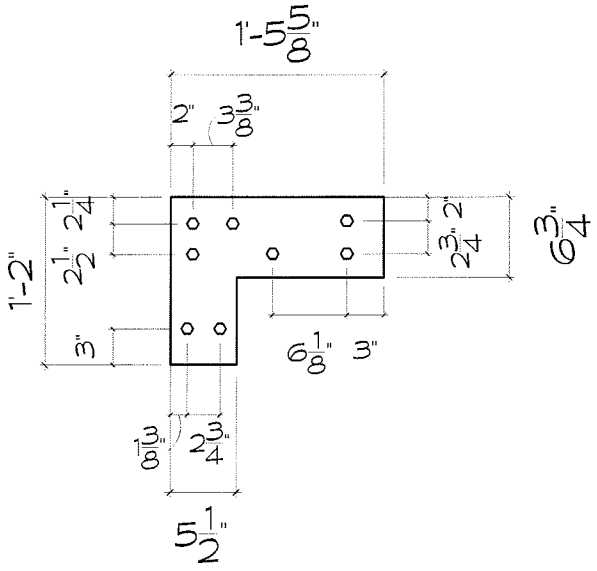
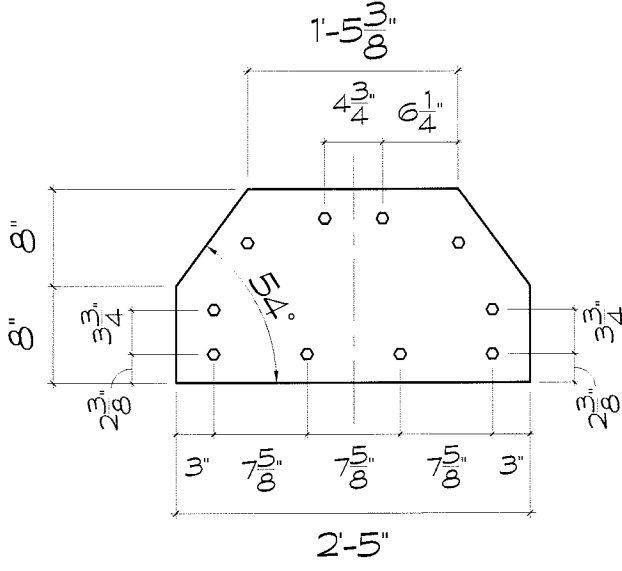
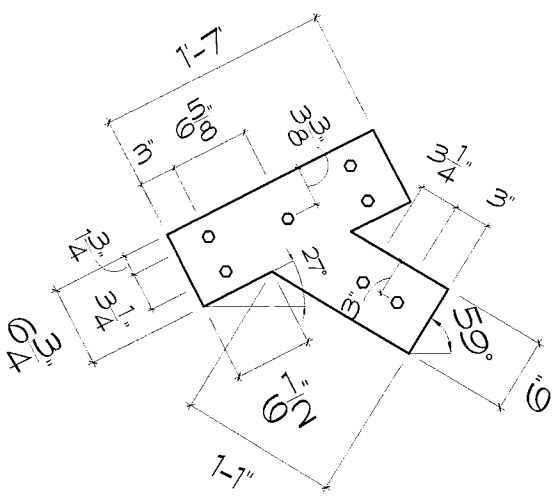
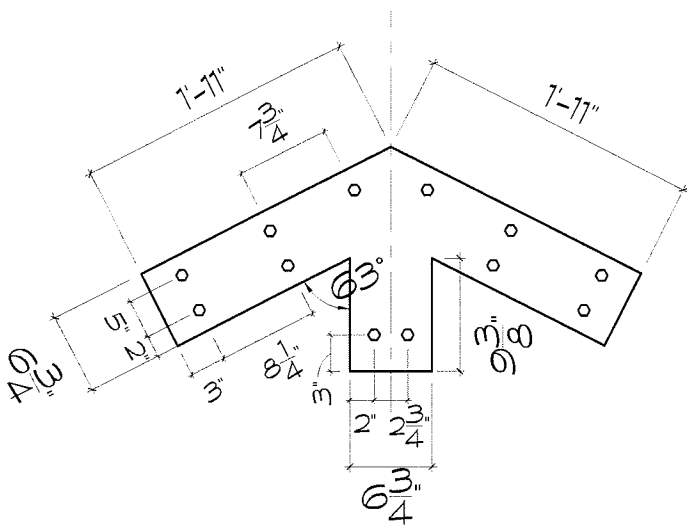

1/4" STEEL PLATES POWDER COATED BLACK WITH 1/2" Ø HEXAGON BOLTS WITH NUTS AND WASHERS. VERIFY PLATE WILL COVER GANG NAIL PLATE. ADJUST AS REQUIRED.

**PLATES**  
 SCALE: 3/4" = 1'-0"

**LADD ENVIRONMENTAL CONSULTANTS, INC.****PRE-CONSTRUCTION CONFERENCE ATTENDEES**

**Project: Monte Sano Trailhead Facilities Pavilion (approximately 31' x 61') with Restrooms  
Including Accessible Parking, RTP Project No. 15-RT-54-02,  
DCNR Project No. 47-P-55, BC Project No. 2018397**

**Location: Monte Sano State Park Lodge, 5105 Nolan Avenue, Huntsville, AL 35801**

**Date: Tuesday, November 13, 2018 at 11:30 AM CST**

	<b>Name</b>	<b>Representing</b>
1	James Payton	Ladd Environmental Consultants, Inc.
2	Ken Thomas	Alabama State Parks
3	Jeffery Thomas	Alabama State Parks
4	Brian P. Moore	Alabama State Parks
5	Pat Sherman	Pat Sherman Architect
6	Phil Horne	DCI
7	Dustin Downey	DCI
8	Blake Redmond	Redmond Contraction